

URINAL BOWL CLEANING INSTRUCTIONS

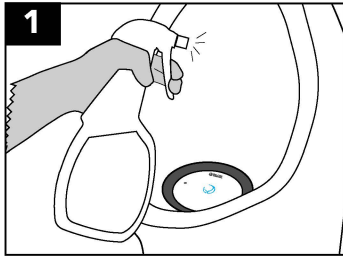

1 Spray (mist) cleaner on entire bowl.

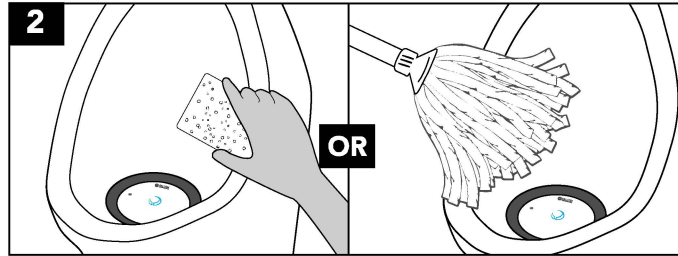

2 Clean outside and inside of bowl with rag, sponge, or mop to remove any debris.

WHEN SHOULD A CARTRIDGE BE CHANGED?

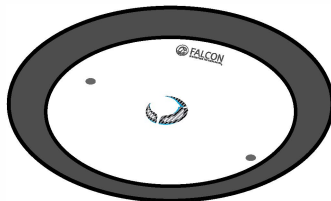

Blue indicator not visible.

OR



Fluid flows very slowly into cartridge.

OR

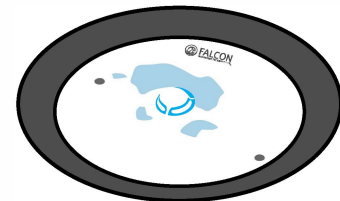

Blue sealant appears on top of cartridge.

VELOCITY CARTRIDGE CHANGING INSTRUCTIONS



1 Insert key into cartridge.

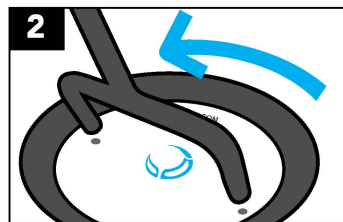

2 Turn key to left (counter clockwise) to unlock.

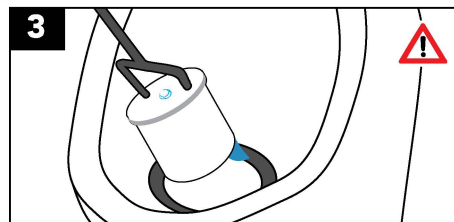

3 Lift and tilt cartridge to drain all free liquids, then spray Falcon Foam Housing Cleaner into housing.

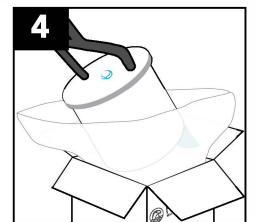

4 Place cartridge into bag, tie bag to seal, and dispose.

 **CAUTION** After removing cartridge from housing, certain naturally occurring but **potentially hazardous sewer gases** may escape through the opening until re-installed properly. If replacement cartridge will not be re-installed immediately, place a rag or paper towels into opening to block any sewer gases. Remove the paper towels or rag prior to inserting new cartridge. Alternatively, use Falcon Foam Housing Cleaner to both clean housing and reduce any outflow of sewer gases through open housing during cartridge change. **Never smoke, have an open flame, or place your nose or mouth near waterless urinal housings into which a cartridge is not yet properly installed.** You also can wear a breathing mask when removing or installing any waterless urinal or cartridge to reduce potential exposure to any such gases.

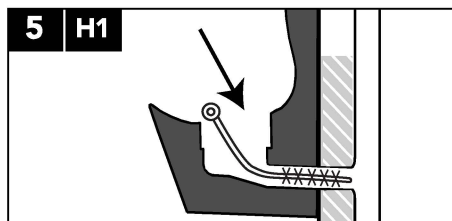

5 H1 Scrub housing and deep inside tailpipe with a long 1.5-inch diameter nylon brush.

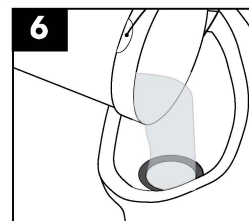

6 Flush housing with 5 gallons (20 Liters) of hot soapy water.

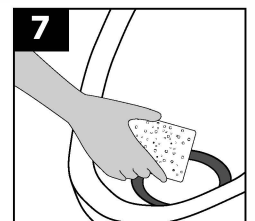

7 Wipe clean inner stainless steel rim.



8 Insert new cartridge into housing and turn key to right (clockwise) to lock and click into place.

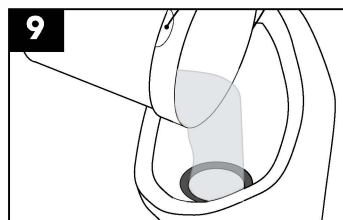

9 Slowly fill cartridge with 1 quart (1 Liter) or more of clean water until there are no air bubbles.



10 Add blue sealant (allow time to drain into cartridge).

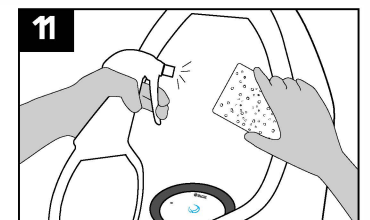

11 Spray (mist) bowl with cleaner and wipe clean.